

RECEIVED  
LARAMIE COUNTY  
CHEYENNE, WY.

CERTIFIED LAND CORNER RECORDATION

'89 AUG 30 AM 8 57

DESCRIPTION OF CORNER EVIDENCE FOUND, AND ORIGINAL RECORD (if known)  
May 10, 1989. Found 1" iron pipe with 3" Brass Cap, stamped

E 1/16 Sec. 15  
Sec. 22  
T.14N, R.70W.

"E 1/16 S15  
S22  
1934"

GLO record "set an iron post 3 feet long, 1 inch diam., 27 ins. in the ground for the east 1/16 fec. cor. of secs. 15 and 22 with brass cap mrkd: "(as found).

DESCRIPTION OF MONUMENT AND ACCESSORIES ESTABLISHED TO PERPETUATE THE ORIGINAL LOCATION OF THIS CORNER:

See sketch for measurement to 1" iron pipe to west and to fence lines.

SKETCH, WITH COURSE AND DISTANCE TO ADJACENT CORNER IF DETERMINED IN THIS SURVEY.  
(May Sketch or Paste Reproduction on Reverse Side.)

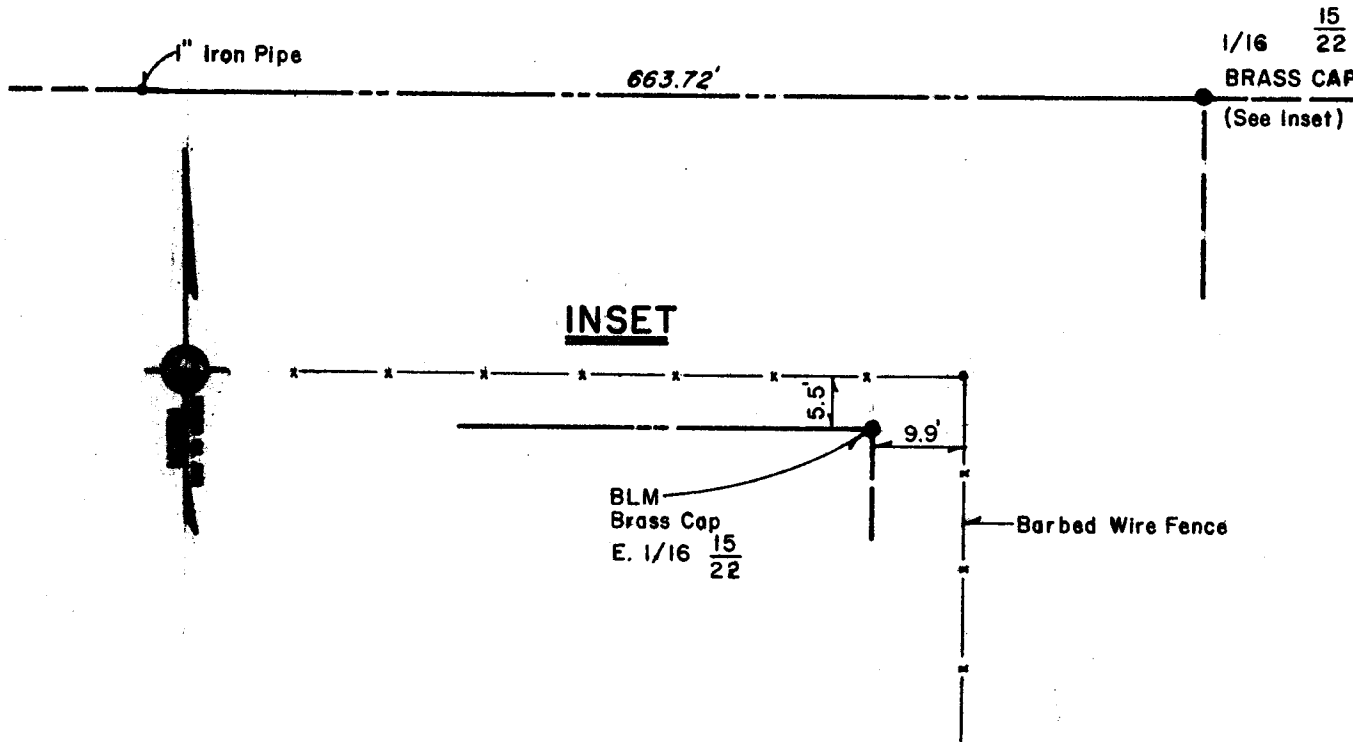

I, BECKY J. BRAMAN certify that I have carefully reviewed the work done on the diagrammed corner as reported on this recordation form and approve the same.

Becky J. Braman PLS 3881  
Signature of Surveyor Date AUGUST 29, 1989 Registration No.

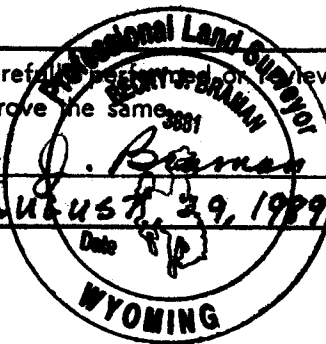

STATE OF WYOMING,  
Office of Clerk and Recorder,  
County of Laramie

This "corner record" was filed for record on the \_\_\_\_\_ day of \_\_\_\_\_, 19\_\_\_\_, was noted on the cross-index plat and is assigned page No. \_\_\_\_\_, in book No. \_\_\_\_\_

Janet C. Whitehead  
County Official  
Cross Index No. N 16 T. 14 N. R. 70 W. Mer.  
\_\_\_\_ T. \_\_\_\_\_ R. \_\_\_\_\_ Mer.  
\_\_\_\_ T. \_\_\_\_\_ R. \_\_\_\_\_ Mer.  
\_\_\_\_ T. \_\_\_\_\_ R. \_\_\_\_\_ Mer.  
\_\_\_\_ T. \_\_\_\_\_ R. \_\_\_\_\_ Mer.  
\_\_\_\_ T. \_\_\_\_\_ R. \_\_\_\_\_ Mer.  
\_\_\_\_ T. \_\_\_\_\_ R. \_\_\_\_\_ Mer.